



PebstechTM
STEEL STRUCTURE

“Carving Ideas into Reality”



OS

*Manufacturing High Quality
PEBs, Light to Heavy Buildings
and Complex Steel Structures.*

OS

Vision

To be the most reliable Pre-Engineered Building Company which delivers the projects on a tradition of Trust through Dedication, Collaboration, Customer Satisfaction and value Creation.

Mission

Our mission is to lead the Pre-Engineered Building Industry by offering clients the highest level of expertise, high quality buildings supported by accurate engineering design through our investment in people, technology and manufacturing facility. Our Values are to be PEB manufacturer of choice, to be the employer of choice, to set the highest standards of ethics, quality and safety; and to achieve a fair balance of responsibility, profitability and citizenship.

Company Profile

PebTech (India) Pvt Ltd is an emerging company in India in the segment of Pre-engineered Steel Building. We are a preferred PEB company in state of Haryana with National footprints. Spread in an area of 2 Acres of land in Panipat, PebTech has PEB manufacturing plant with a capacity of 6000 MT per annum and can be enhanced further to meet the growing market demand. We have a major focus on quality works, volume and customer centric approach by investing in people and technology.

We have highly skilled team of designer and detailers who use updated design software like MBS, STAAD Pro and the TEKLA Structures 3-D software for highly professionalised detailing to achieve optimum, flawless and efficient engineering solutions. We use variety of design codes such as AISC, MBMA, AWS, ASCE, IBS, IS etc. for the PEB of customer's needs in various parts of country and abroad.

We are an ISO 9001-2015 certified company which offer bundle of solutions with quality assurance in terms of wide range of products required for Pre-engineered Buildings.

PebTech source steel from top steel suppliers to ensure quality of raw material. All the primary and secondary accessories are being purchased only from the best supplier of their segment to have best building.

PebTech has a wide range of clientele across India and abroad. We have supplied buildings in various categories viz. factories building, warehouses, showrooms, commercial/ trade centres, supermarkets, sports stadiums, exhibition halls, aircraft hangars, hospitals, food, pharmaceuticals, textile etc.

We are one stop solutions for varieties of products ranges from PEB Buildings, turbo ventilators, ridge ventilators, profiled sheets, deck sheets and various other related products. Our product and quality service deliverance result in sturdy construction with dimensional accuracy, easy installation and low maintenance with excellent performance.

PebTech Pre-Engineered Buildings

PEBs are designed and fabricated to meet clients requirements in accordance with the universal standards. It consist of four important components viz primary members, secondary members, roof & cladding system and connection fasteners. These components are fabricated in factory under full quality control as per shop drawings.

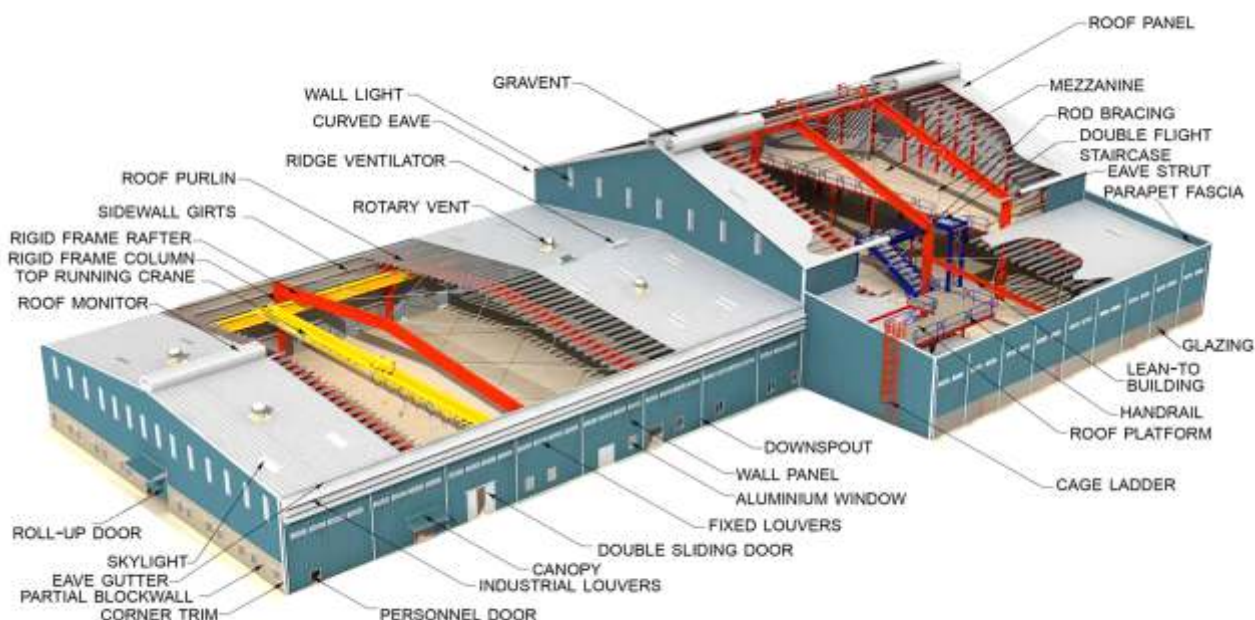

Standard Frame Types

Tapered Column Clear Span

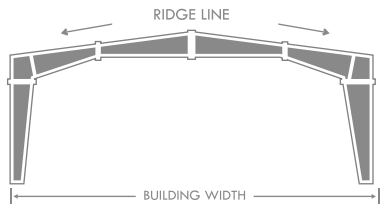

Multi Gable

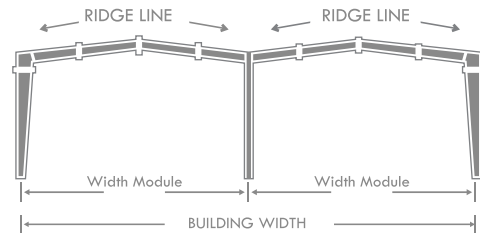

Multi Span I

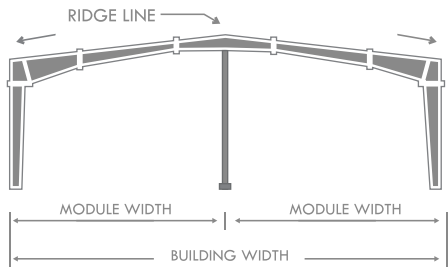

Mono Slope

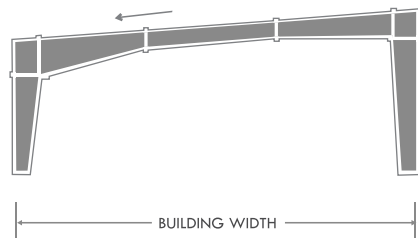

Multi Span II

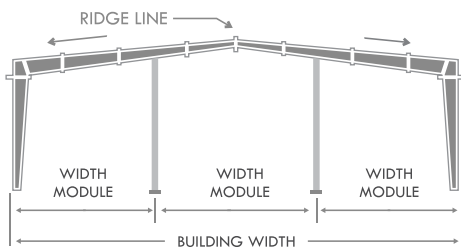

Lean - To

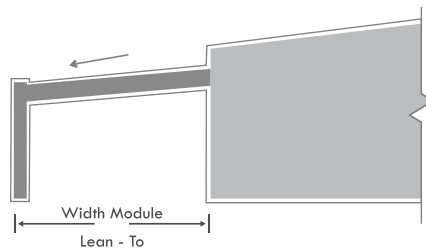

Multi Span III

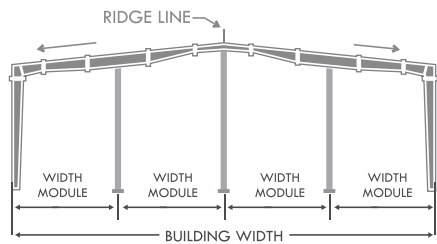

Multi Span I with Crane & Mezzanine

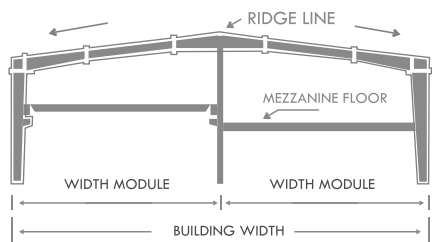

Exploring New Frontiers of construction technology and adding a new perspective to existing system design

Crane :

When there is crane system, the supply includes columns, rafters, brackets, crane runway beams and lateral tie that support crane system. Client have to provide complete crane data as per crane's manufacturer for optional designing of PEB having crane system.

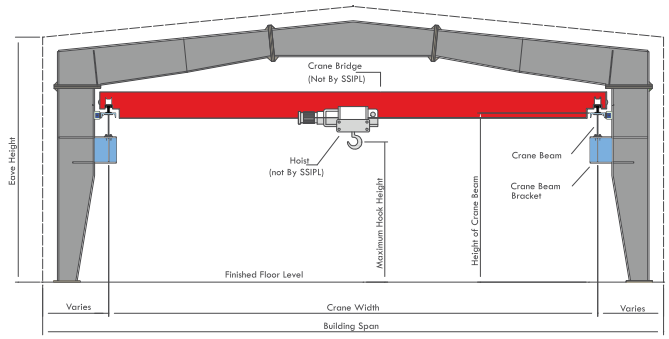

Mezzanine :

The mezzanine framing system consist of deck supported by joist into main mezzanine beams. Mezzanine provides permanent formwork as well as positive reinforcement. MS Deck sheet is used for suitable load on floor and covered with form concrete.

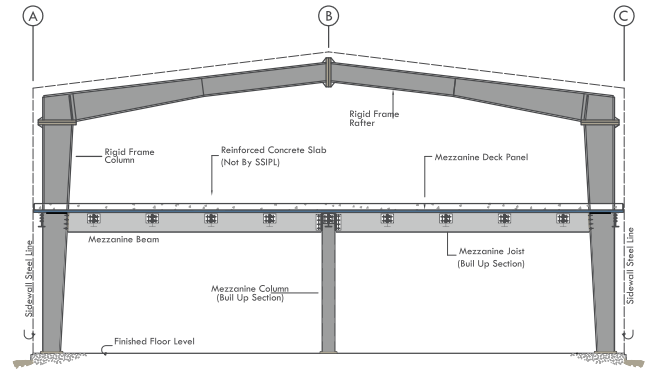

Jack Beams :

For creating longer bay length when large unimpeded space is required, jack beams are used.

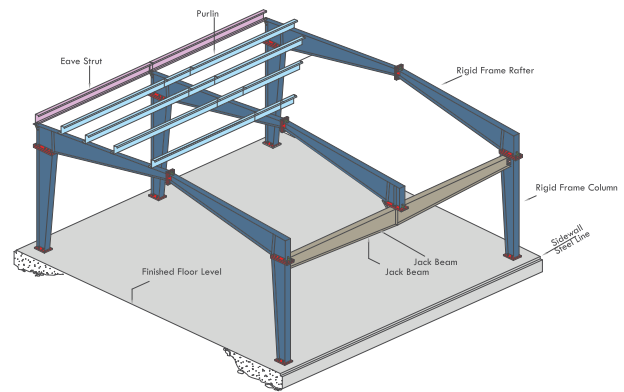

Roof & Wall Pannel :

Steel panels are most attractive features of metal building System. Terms "Panels" refers to the metal skins used as roof and wall panels, interior roof and wall liners, partition panels, fascia panels, soffit panels etc.

PebTech High Rib Sheet

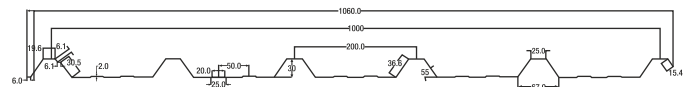

PebTech Deck Sheet

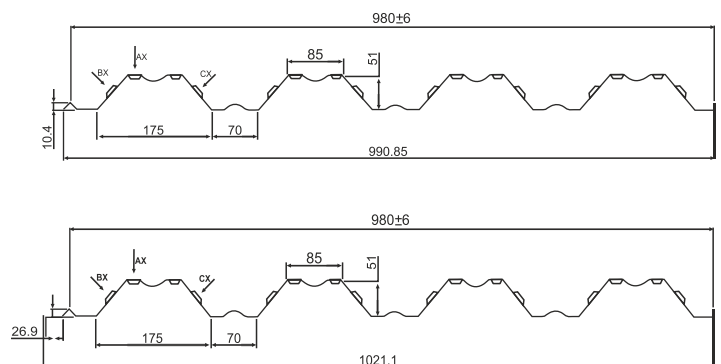

PebTech Standing Seam Sheet

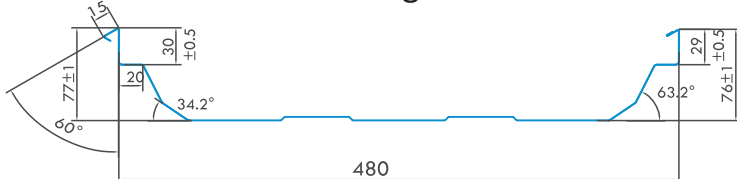

Accessories

Ridge Vents

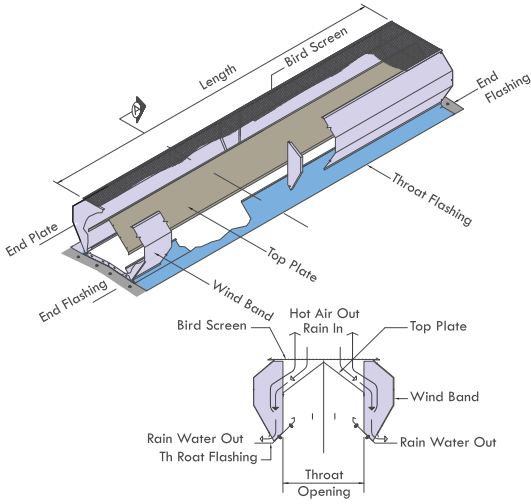

Turbo Vents

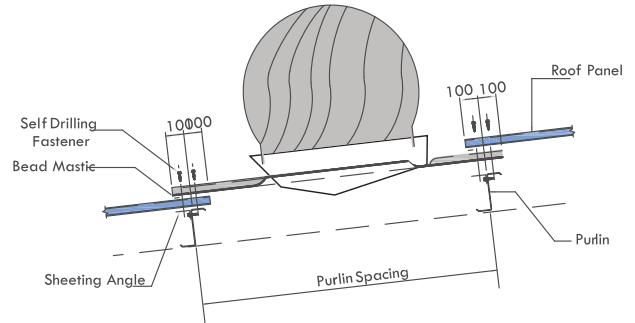

Skylight

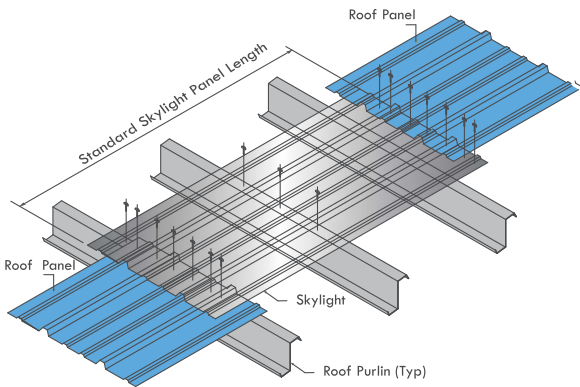

Roof Monitor

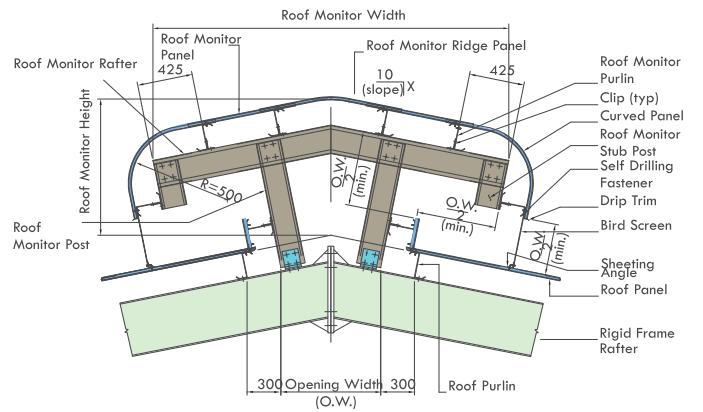

Insulations

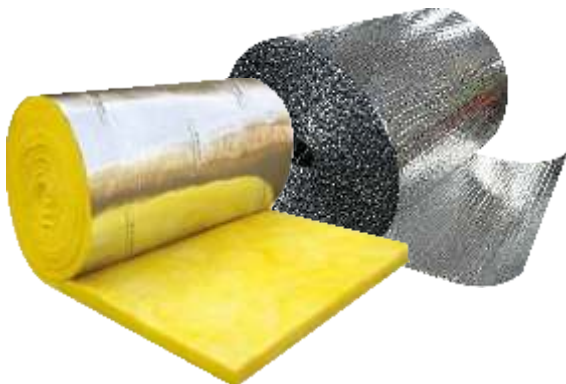

Advanced Designing & Manufacturing Techniques, Seismic Resistant Steel Structure.

Our Projects



Magpet Polymer Pvt. Ltd.

Location : Hooghly, West Bengal
Area : 50,000 Sq.ft.

Patanjali

Location : Nagpur, Maharashtra
Area : 55,000 Sq.ft.



Saras Beverages

Location : Parasi, Nepal
Area : 80,000 Sq.ft.



Reliable Information

Location : Bhiwadi, Rajasthan
Area : 90,000 Sq.ft., G+2



Anaya Earth Foundation

Location: Yamuna Nagar, Haryana
Area : 20,000 Sq.ft.



Binayak Wood

Location : Birat Nagar, Nepal
Area : 40,000 Sq.ft.

MNH Industries

Location : Patiala, Punjab
Area : 50,000 Sq.ft.



National Polymer

Location : Bhiwadi, Rajasthan
Area : 30,000 Sq.ft.

Kasa Feed Mills

Location : Rajpura, Punjab
Area : 50,000 Sq.ft.



Saria Green Bricks

Location : Jhapa, Nepal
Area : 2,25,000 Sq.ft.

***Designing PEB Solutions to
give You a Robust,
Cost Effective and Innovative
Structure as per
Your Business Needs***

OUR CLIENTS



Plant / Office

PebstTech (India) Pvt Ltd
PebstTech Building Products LLP
Pasina Khurd Road, Village- Sewah,
Panipat-132103
Haryana, India

mobile
+91- 9996551232
+91- 9911132145

email
info@pebstech.com

website
www.pebstech.com

